



# ELEPHANT FX

user manual

**READING AND UNDERSTANDING**  
instruction for use are required to use this product.



## 4. INSTRUCTION FOR USE

**D Releasing** - You will release system by pulling the brake handle. Hold the loose end of rope by hand the whole time and release it fluently! To make releasing easier, you can clip a carabiner with a sling to the hole so you will elongate the brake handle.

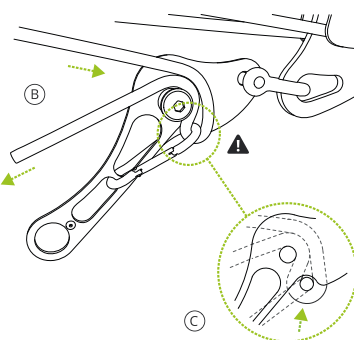
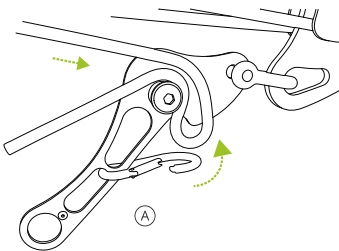

## 1. WARNING

For slacklining only. Understand and accept the risks involved before participating. You are responsible for your own actions and decisions. Before using this product, read and understand all instructions and warnings that accompany it and familiarize yourself with its proper use, capabilities and limitations. Contact Equilibrium Slacklines if you are uncertain about how to use this product. Do not modify this product in any way. Check the condition of product components before and after each use. Failure to read and follow these warnings can result in severe injury or death!

Maximum tension is **4 kN**.

ELEPHANT is not certified for usage in heights. Do not use this device higher than 1 m above the ground.

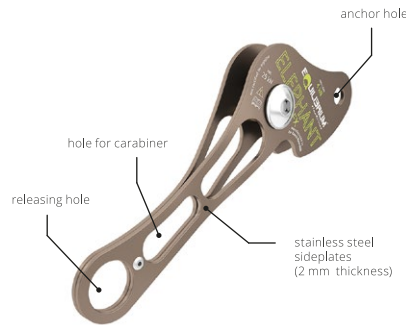

## 2. DESCRIPTION

Elephant is a rope brake specially designed for slackline pulley systems with rope of 8 mm diameter. Simple blocking principle, high reliability and easy releasing device with small dimensions. Elephant can be attached to a separate anchor sling or rigging plate by a shackle or carabiner. If combining with pulleys Minima or Quatron, you can attach Elephant with a 6 mm shackle directly to the middle sideplate of the fix pulley (on the tree side). Working load limit (WLL) is 400 kg. Overloading causes higher wear and tear of the static rope coating, or slipping of some types of ropes.

## 3. SAFETY RECOMMENDATIONS

Always tie a stopper knot on the loose tail of rope (the piece of rope that comes out of the rope brake) to prevent slipping of the rope under high tensions. Always backup the device with a separate sling or a piece of rope to a secure anchor to prevent the metal parts flying around in case of the anchor failure. If you lack experience, use this equipment under proper supervision.

## 4. INSTRUCTION FOR USE

- A Instalation** - Make a bend on rope and put it through the brake. Loose end of rope must be underneath the tight end. Clip the carabiner on brake through the rope bend. Make sure, that the biner clicks into the brake groove.
- B Tensioning** - Use the loose end of rope to create multiplier of main pulley system. We recommend to use a rope grab (ascender) to increase the rigging efficiency. Do not manipulate with the releasing lever while tensioning.
- C** Make sure that the carabiner is correctly positioned in the groove to achieve an adequate

## 6. CARE AND MAINTENANCE

Slacklining gear must not come into contact with corrosive materials such as battery acid, battery fumes, solvents, chlorine bleach, antifreeze, isopropyl alcohol or gasoline.

After contact with saltwater or salt air, always rinse the product with fresh water and dry it perfectly. Store in a dry place.

## 8. CONTACTS

Need help? Any questions?  
Comments, compliments, complaints?

Check out [www.eqb.cz](http://www.eqb.cz) or write us at [info@eqb.cz](mailto:info@eqb.cz)

This product was completely designed by handsome slackliners and manufactured in the Czech Republic.

## 4. COMPATIBILITY

ELEPHANT FX IS COMPATIBLE WITH THESE CONNECTORS:			
connector	size	pin	bow
inox shackle	6 mm	✓	✓
	8 mm	✓	✓

## 5. SPECIFICATION

ELEPHANT FX TECHNICAL SPECIFICATIONS:	
maximum load	4 kN
minimal breaking strength	25 kN
weight	130 g
dimensions	160 x 55 x 30 mm
main diverter diameter	14 mm
inner width	10 mm

